

# SURE • SEAL™

(PATENTED)

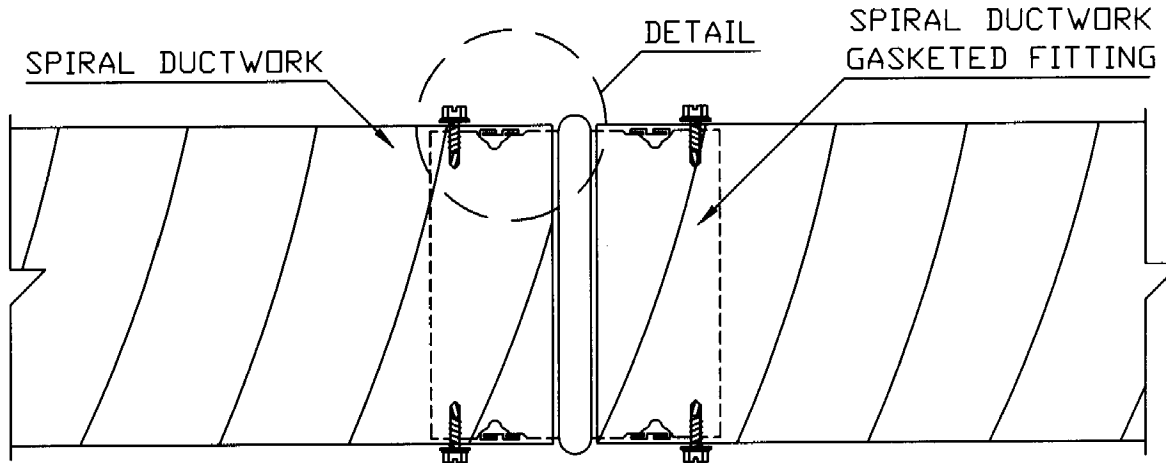

SURE SEAL™ DETAIL  
SINGLE WALL SPIRAL DUCTWORK

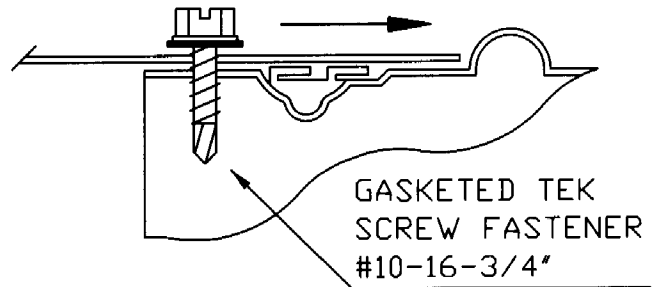
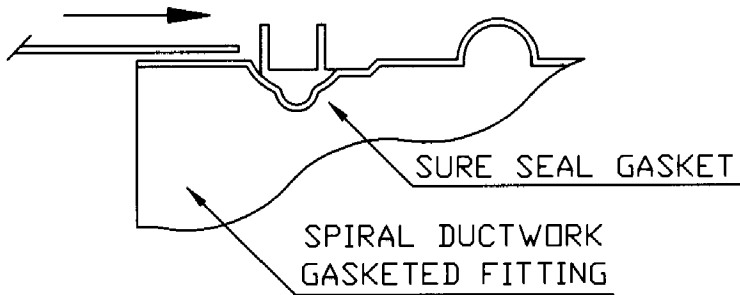

SURE SEAL™ DETAIL  
DOUBLE WALL SPIRAL DUCTWORK

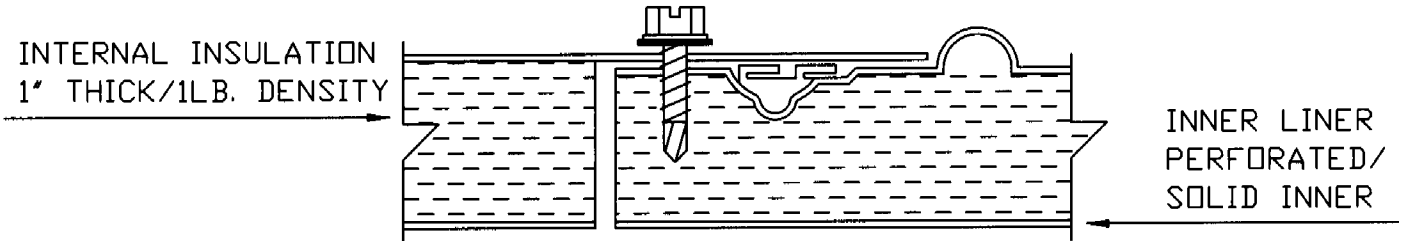

PROFILE  
EPDM RUBBER GASKET

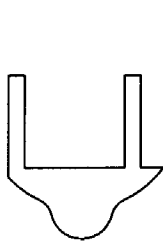
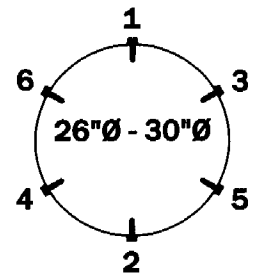
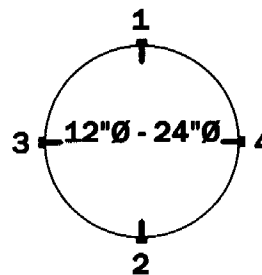
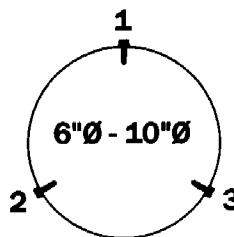
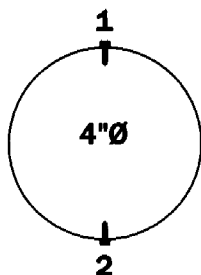

DIAGRAM BELOW SHOWS TEK SCREW  
QUANTITY AND PLACEMENT SEQUENCE



[www.langdonsheetmetal.com](http://www.langdonsheetmetal.com)

Cincinnati, Ohio. 45215  
The above mentioned product, is protected by pending patents and trade marks  
All Rights Reserved updated 3/7/13

## **Sure Seal Spiral Galvanized Specifications**

A. General : Fabricate single wall ducts, elbows, transitions, offsets, branch connections, and other construction according to SMACNA's "HVAC Duct Construction Standards - Metal and Flexible" and complying with requirements for metal thickness and minimum gauge as shown, reinforcing types and intervals, and joint intervals per static pressure class indicated.

1. Lengths : Fabricate round ducts in lengths appropriate to reinforcement and rigidity class required for pressure class. 10'-0" maximum lengths.
2. Deflection : Duct systems shall not exceed deflection limits according to SMACNA's "HVAC Duct Construction Standards - Metal and Flexible".
3. Round Fittings : Fabricate fittings to match adjoining ducts, and to comply with duct requirements as applicable to fittings. Provide fitting types as indicated on drawings.
4. Round Elbows : Except as otherwise indicated, fabricate elbows with center-line radius equal to 1-1/2 times associated duct width. Where installation requirements prevent the use of fitting types indicated on the drawings and/or with center-line radius equal to 1-1/2 times the duct width, provide center-line radius equal to 1 times the duct width.
5. Ductwork leakage rates not to exceed 2 cfm per 100 square feet at 10" W.G. positive pressure.

B. Material :

1. Galvanized ASTM A527.

C. Minimum Fittings Gauge (10" W.G. positive pressure) :

1. Fitting : 24 GA 4" to 24" diameter, 22 GA 26" to 30" diameter.

D. Longitudinal Seams :

1. Ductwork Seams : ( RL-1 ) Spiral Seam.
2. Fittings Seams : ( RL-3 ) Lap and spot weld on 2" interval.
3. Seal seams in accordance with SMACNA's HVAC Duct Construction Standard - Metal and Flexible.

E. Transverse Joints: Integral gasketed ductwork system.

1. Manufacturer :

Langdon Inc.  
9865 Wayne Ave Cincinnati, Ohio 45215  
Phone (513)733-5955 ext.238 Fax (513)733-8050  
www.langdonsheetmetal.com  
Attn. : Joe Sandman. Mobile # 513-678-6825

- a. Sure-Seal Spiral, even sizes 4" diameter to 30" diameter.
- b. Slip Joint Connection : Continuous machine formed groove with gasket.
- c. Gasket : EPDM rubber with a dual lipped profile. Temperature range : -20 F to +200 F.
- d. Secure joint with gasketed #10-16-3/4" tek screw as recommended by manufacturer.